

Pelvic Health and Essential Pelvic Health Treatment Table User Manual

Applies to the following Models:

EPT9045

PT9045



*PT9045 with Dual Footbar
Control, Battery, and
Custom Base Color*



Important! This User Manual contains important information for the user of the product. All who use this product should review and completely understand its contents. Remember to keep this manual in a place where it is always available to those using the product.

Table of Contents:

Introduction: 2

Safety Precautions & Definitions: 3

Installation & Unpacking: 5

Technical Specifications: 7

Operation: 8

Preventative Maintenance:..... 11

Upholstery Cleaning & Care: 12

Service: 12

Troubleshooting: 13

Replacement Parts: 14

Warranty: 15

Manufacturer Contact Information: 15

Introduction:

Intended Use: The Pelvic Health Treatment table is intended for use in a clinical environment to support patients during treatment.



Safety Precautions & Definitions:

If you need assistance, contact
Pivotal Health Solutions service
at 1-800-743-7738.



WARNING: Never leave patient on table unattended.



CRUSH HAZARD: Powered components used to elevate and lower this table present a potential crush hazard. KEEP CHILDREN AWAY FROM TREATMENT AREA. Allow only the patient and authorized staff in treatment area.













ELECTRICAL CONNECTION: For your personal safety, this table must be grounded. This table is equipped with a power supply cord having a three (3) prong grounding plug. To minimize possible shock hazard, it must be plugged into a mating three (3) prong grounding type wall receptacles, grounded in accordance with the National Electrical Code and local codes and ordinances. If a mating wall receptacle is not available, it is the responsibility and obligation of the customer to have a properly grounded three (3) prong wall receptacle installed by a qualified electrician. Power requirements of the table are found in the Technical Data Section.

Before using this equipment follow the following safety precautions:

- Before using this equipment make sure you have read and understand this entire manual.
- Explain proper use to all employees. This table should be used only by qualified, trained personnel.
- Never exceed the table's maximum supported weight.
- DO NOT SIT, LEAN, OR OTHERWISE OVERWEIGHT TILTING HEADPIECE OR ARM SECTIONS. These tilting sections are not meant to hold more than the weight of the body part that the piece is intended to hold.
- Connect table only to an outlet that is grounded and connected to a circuit with a fused circuit breaker in accordance with the National Electrical Code and local codes and ordinances.
- Use only on dry surfaces. Ensure the tables feet do not slide.
- Make sure casters are locked.
- This table is NOT for patient transport.
- NOT intended for use with accessories other than those indicated in this manual.
- Do not operate the table in an environment where other devices that intentionally radiate electromagnetic energy in an unshielded manner are present.
- Always explain to the patient how to properly get on and off the table. Be sure to assist patient to prevent falls.
- Keep patient's hands positioned on the top side of cushions at all times.
- Keep hands and feet away from moving parts and pinch points.
- Ensure controls have locked properly prior to positioning or releasing patient.
- Never leave patient unattended on table.
- Follow preventative maintenance instructions provided in this manual.
- Ensure all components have been inspected for damage and are fully functional.
- Inspect cables and connectors before each use.

Warning and Precautions through this manual are indicated by specific symbols. Applicable symbols are shown below along with a description of the symbol. Review these symbols and all safety precautions before operating the table.

	CAUTION: Text with a “CAUTION” indicator will explain possible safety infractions that could have the potential to cause injury.
	WARNING: Text with “WARNING” indicator will explain possible safety infractions that will potentially cause serious injury and equipment damage.
	Pinch Point: Indicates space between manually adjustable moving and stationary parts where body parts may become caught, leading to minor injury.
	Warning: High Voltage
	Crush Hazard: Indicates space between powered moving and stationary parts that represent a potential crush hazard.
	Instructions for Use: Indicates the need for the user to consult the instructions for use.
	EXPLOSION HAZARD Text with “EXPLOSION HAZARD” indicator will explain possible safety infractions if this equipment is used in the presence of flammable anesthetics.
	Contains electronic materials. Recycle and dispose of device properly in accordance with local, state and federal laws.
	Indicates the device manufacturer.
	Indicates the product is a medical device.



WARNING: Under no circumstances should the table be modified from its original design. Contact Pivotal Health Solutions if you need help with service.



DANGER: Possible explosion hazard if used in the presence of flammable anesthetics.

Installation & Unpacking:

A MINIMUM OF TWO PEOPLE ARE REQUIRED TO LIFT AND MOVE THE TABLE. LIFT THE TABLE BY THE BASE FRAME!



WARNING: Do not install/use this equipment adjacent to, or stacked with, other equipment as it could result in improper operation. If such use is necessary, this equipment and the other equipment should be observed to verify they are operating normally.

After removing the top and side panels of the shipping crate, you may notice metal bands and plastic cable ties. These are used to secure various sections of the table and must be removed. Once all bands and cable ties are removed, the table must be lifted directly upward in order to clear all shipping restraints.

Once the table is out of the shipping container, place table in a level location and inspect the table cushions, frame, cables, etc. for damage. If no damage is noted, plug in the table and test the elevation, drops, and any other options that are on your table. Contact Pivotal Health Solutions or your dealer with any questions or concerns.

If the optional battery was purchased, the battery should be charged continuously for at least 24 hours before use.

Instructions for Damaged Merchandise: The contents of this shipment have been checked and packed by experienced personnel. If your company arranged the shipping, damage should be noted on the Bill of Lading before signing to accept the shipment, then articles damaged in transit should be reported at once to delivering carrier and a claim must be filed by you. If freight was arranged by Pivotal Health Solutions, note any damage on the Bill of Lading before signing acceptance of product and notify Pivotal Health Solutions right away. Failure to inspect for shipping damage prior to signing for the product may affect your warranty. We can neither be responsible for, nor can we accept the return of merchandise damaged in transit during shipment arranged by outside parties.



WARNING: Portable RF communications equipment (including peripherals such as antenna cables and external antennas) should be used no closer than 30 cm (12 inches) to any part of the Thera-P Electric Treatment table including cables associated with the Thera-P Electric Treatment Table. Otherwise, degradation of the performance of this equipment could result.

Installation of PHO-1030, Bracket for the knee support stabilization arm.

1. Locate the knee support cushion, support slider, and stop screws.

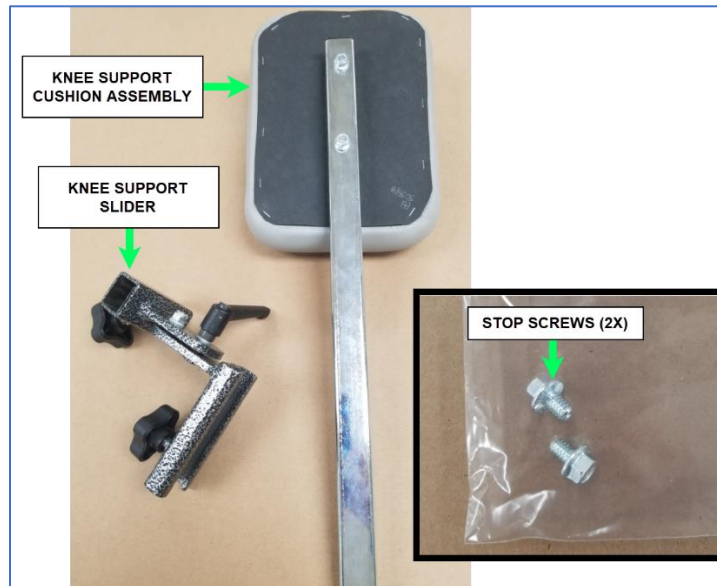

2. Slide the support slider onto the slide rail assembly. Tighten the locking knob.

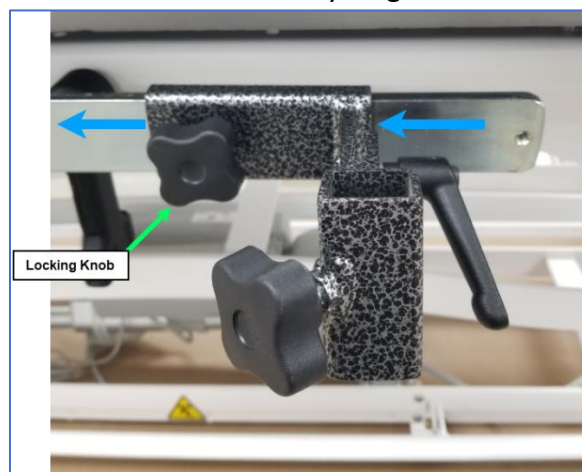

3. Slide the knee support stabilization arm into the support slider and then thread one slide stop screw into the threaded hole at the end of the slide rail.

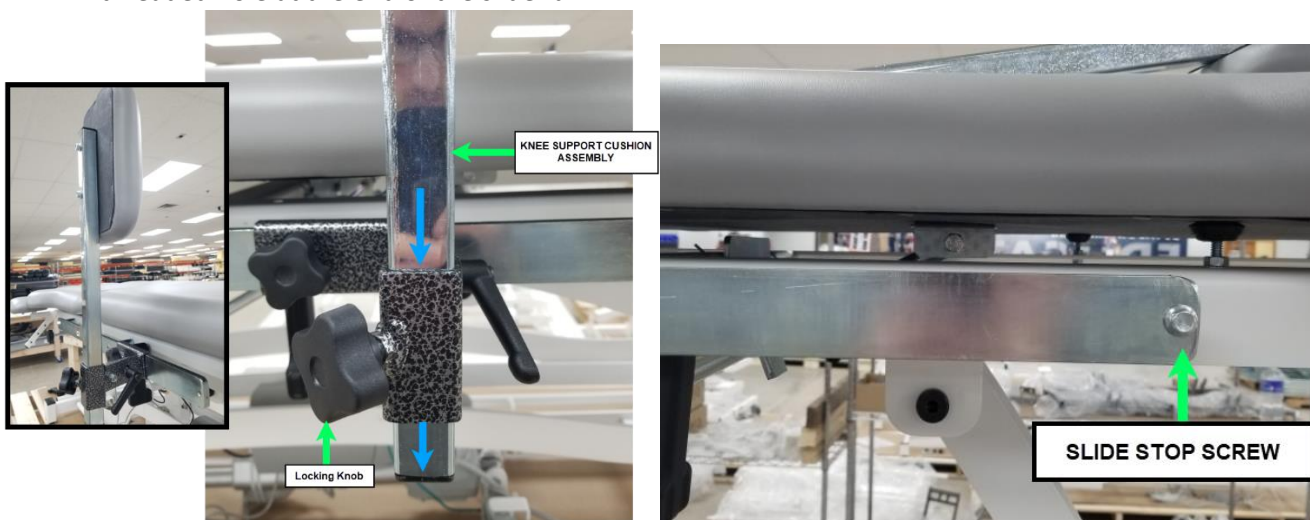

Technical Specifications:

Base Model Number	PT9045	EPT9045
Model Name	Pelvic Health Table	Essential Pelvic Health Table
Dimensions	30" W x 77" L	
Height	17" to 35" H	
Head Angle	+40° to -90°	
Mid-Section Angle	0-17°	
Lower Extremity Angle	0 to 65°	
Armrest Horizontal Range	0 to 45	
Armrest Vertical Range	0" to 7"	
Foam	2" High density foam cushions with rounded corners	
Rated Voltage	120V	
Rated Frequency	50/60 Hz	
Rated Current	10A	
Fuse Type	No user serviceable fuse	
Safe Working Load	650 lbs (294.8 kgs)	
Duty Cycle	2 Minutes on, 18 Minutes off	
Electrical Classification	Class I	
Electrical Type	 Type B	
IP Rating	Foot Pedal - IPX1; Other components – see component	
Power Cord (120V)	96 in (243 cm) cable length, 10A, unshielded	



WARNING: Keep table out of high moisture areas. For indoor use only.

Operating Conditions: This table should be operated, between 40° F (4.4° C) and 100° F (37.8° C), with relative humidity ranging from 30% - 80%.

Transport & Storage Conditions: This table should be transported and stored in temperatures between -40° C (-40° F) and 70° C (158° F) with relative humidity 10%-100%.

Expected Life: This product has an approximate expected life time of 10 years when correctly handled, serviced, and inspected in accordance with these instructions.

Design and Quality: Pivotal Health Solutions is certified in accordance with ISO 13485, the standard for the medical device industry.

Product Changes: Pivotal Health Solutions, Inc. reserves the right to make products changes without prior notice. Contact your Pivotal Health Solutions representative for advice and information about product upgrades.

Operation:



WARNING: Use of accessories and cables other than those specified or provided by Pivotal Health Solutions could result in increased electromagnetic emissions or decreased electromagnetic immunity and result in improper operation.



WARNING: This equipment generates, uses, and can radiate radio frequency energy and, if not installed and used in accordance with the instructions, may cause harmful interference to other devices in the vicinity. However, there is no guarantee that interference will not occur in a particular installation. If this equipment does cause harmful interference to other devices, which can be determined by turning the equipment off and on, the user is encouraged to try to correct the interference by one or more of the following measures:

- Reorient or relocate the receiving device.
- Increase the separation between equipment.
- Connect the equipment into an outlet on a circuit different from that to which the other device(s) are connected.
- Consult the manufacturer or field service technician for assistance.



WARNING: Not for patient transport.



CRUSH HAZARD: Powered components used to elevate and lower this table present a potential crush hazard. KEEP CHILDREN AWAY FROM TREATMENT AREA. Allow only the patient and authorized staff in treatment area.



PINCH POINT: Always keep patient's hands positioned on top side of cushions when lowering, raising and tilting table to keep from potential pinch points.

Note to user: If a serious incident occurs, report the incident to Pivotal Health solutions. (See section with Manufacturer Contact Information for contact details). If the incident occurs in the EU, also report any serious incident to the Competent Authority of the Member State in which the user and/or patient is established.

Table Setup and Assisting Patient onto Table:

- 1) Ensure the table is in lowest position and flat configuration prior to start.
- 2) The patient should load onto the table on the side opposite the knee support stabilization cushion.
- 3) The practitioner or trained staff should always assist the patient on the table. Do not allow the patient to get on the table by him/herself.

- a. Patient should sit on center cushion then swing feet up onto the table.
- b. Patient should not sit on the corners of the table nor the head or foot end.
- 4) The patient should check clothing for keys, wallet, belt, or any other items that may cause discomfort during treatment or damage upholstery.
- 5) Never leave patient unattended while on the table.

**DO NOT SIT, LEAN, OR OTHERWISE
OVERWEIGHT HEADPIECE, ARM REST, or
LEG STABILIZATION SECTIONS.**

Table Operation:

- 1) To begin treatment, ensure table is in lowest position and flat.
- 2) Position the patient on the table as above.
- 3) Elevate to the desired height for treatment once the patient is in place.
 - a. If optional battery is being used, press the ON button for > 1 second prior to elevating the table.
 - b. If battery LED is blinking orange, the battery should be charged.
- 4) Adjust the knee support stabilization cushion as needed and lock knee support slider in place.

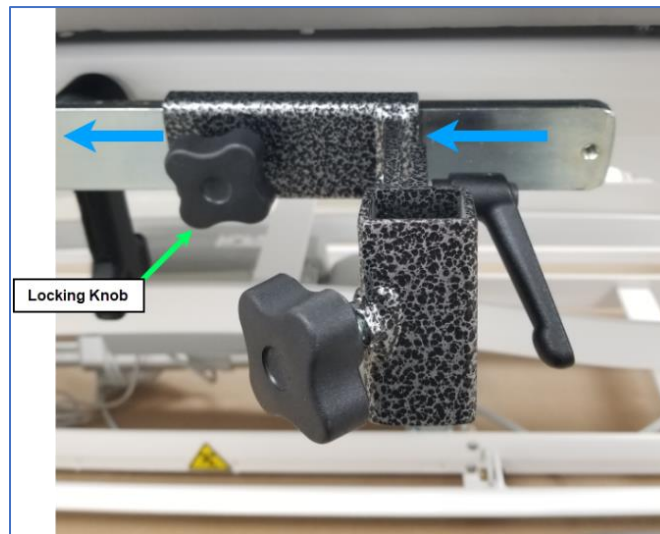

- 5) Perform the treatment desired. Refer to the 'Operation' section and/or the individual component functions below for operation of specific table features
- 6) After treatment, return the table to a level and straight configuration.
- 7) Lower the table to the lowest position by pressing the foot pedal, or if the table is equipped with a foot bar, hold the foot bar up to lower the table.
 - a. If optional battery is being used, press the OFF button for > 3 seconds to turn battery off once treatment is complete.

Assisting Patient off of Table:

- 1) Caution the patient not to get up from the table alone so as to prevent any strain that could void the treatment, and to ensure the patient is not lightheaded from lying down which can cause imbalance.
- 2) Allow patient to get full balance before coming to a standing position. Best practice is to keep a hand on the patient at all times.
- 3) **Patient should exit table on side opposite of the stabilization arm.** If stabilization arms, or brackets for arms are installed on both sides of the table, help the patient avoid any contact with the arm or bracket.

Table Options and Features:

Battery Installation:

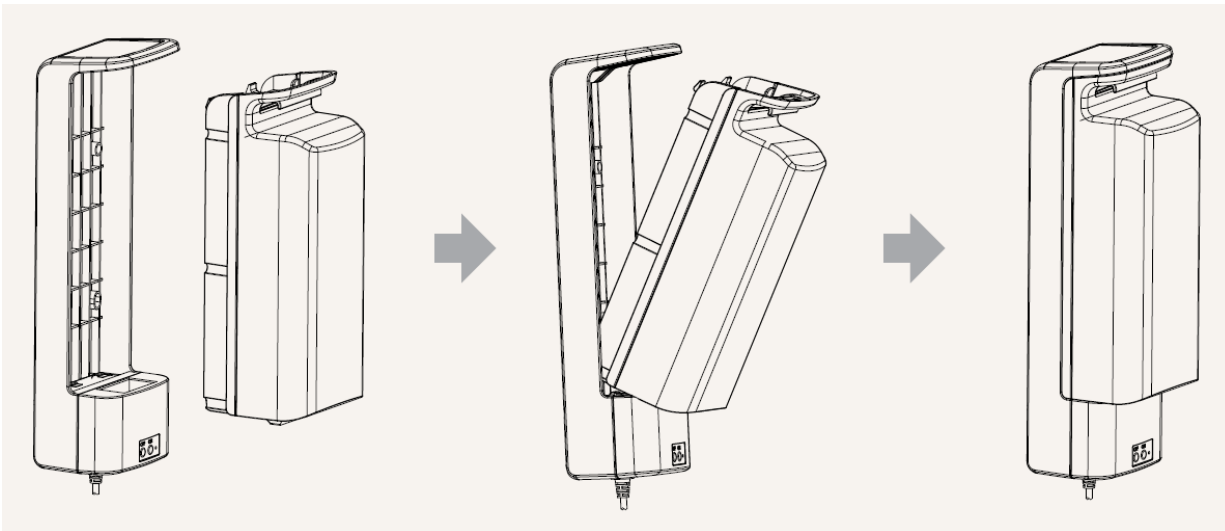

Interpreting Battery LED for status determination when on table:

Status	Capacity	LED	
Hi charging	>80%	Green	Continuous on
Charging	<80%	Green	Short dimming (1 sec / 1 sec)
Hi battery	>25%	Green	Long dimming (0.5 sec / 4 sec)
Low battery	<25%	Orange	Long dimming (0.5 sec / 4 sec)
Protection	<20%	-	Off
Failure	-	Orange	Continuous on

Interpreting Battery LED for status determination when charging the battery:

Note: From low battery to a fully charged battery takes approximately 10 hours.

When charge by TP7C, TBB7 LED become off, and the status only shown on TP7C-

Status	Capacity	LED	
Hi charging	>80%	Green	continuous on
Charging	<80%	Orange	continuous on

Elevation:

- Use the Table Height Adjustment foot pedal or optional foot bar to raise and lower the table height.

Foot Bar: (Optional)

- Step on foot bar to raise table. Release at desired position. Lift foot bar with toe of shoe to lower table.

Tilt Sections:

- Lift on cushion to tilt up. Cushion position will lock automatically. To lower, support cushion and twist lock lever to unlock the cushion. Lower the cushion to the desired angle, and release twist lock lever. Make sure to hold cushions by side, not ends to avoid pinch points.

Standard Electric Elevating Midsection:

The PT9045 comes standard with the Electric Elevating Midsection. The electric elevating midsection is operated with a hand control that features the up and down option.

Hand Control
S1195



Preventative Maintenance:



WARNING: Disconnect table from power source before wiping down mechanical parts to avoid personal injury.

INSPECTION:

At least monthly the table should be thoroughly inspected for wear and tear, loose hardware and parts, and other damage.

- Inspect the table to make sure that there is no external damage or loose hardware. Tighten loose hardware. Hardware that does not tighten needs replacement.
- Inspect table for obvious signs of damage or wear such as cracked welds, loose bolts, frayed or damaged cords. Do not use a table with damaged cords.
- Check moveable components (electrical and non-electrical) to ensure functionality.
- Check components to ensure they lock and function properly.
- **Contact Pivotal Health Solutions with questions or concerns.**

LUBRICATION:

It is recommended that every six (6) months the table drive bearings be lubricated using a light machine oil such as 3-in-1 oil. Do not over lubricate as it is of no value and will collect dust and dirt. Wipe down remaining table mechanism with a clean rag.

Upholstery Cleaning & Care:



CAUTION: Read carefully, improper cleaning will void the warranty. Never use alcohol-based cleaning agents.

DISINFECTING: There is a disinfecting wipe on the market called *Protex Ultra Disinfectant Wipes*. Many of our customers use these.

FOR DAY TO DAY CLEANING: A solution of 10% mild household liquid dish soap with warm water, applied with soft damp cloth. Rinse with clean water and dry.

FOR STAINS: Dampen a soft white cloth in a one to one (1:1) solution of Fantastik® and water OR Formula 409® and water. Rub gently and rinse with a water dampened cloth.

FOR MORE DIFFICULT STAINS: Dampen a soft white cloth with a solution of household bleach (10% bleach / 90% water). Rub gently and rinse with a water dampened cloth to remove bleach concentration.

WHAT NOT TO USE: Using the wrong cleaning agents you will VOID YOUR WARRANTY and crack, dry out and destroy your vinyl. Do not use any cleaning agents that contain alcohol, harsh chemicals or abrasives.

Service:

Refer to Warranty section in this manual for specific warranty information.

When replacing worn parts, use genuine Pivotal Health Solutions, Inc. parts by contacting our service department. When ordering replacement parts:

- Ask for the service department, 800-743-7738
- Have the model number and serial number available
- Specify parts by the numbers/description below

Troubleshooting:

No Power	<ol style="list-style-type: none">1. Verify power supply connections.2. Check that outlet is working and breaker is not tripped.3. <i>If the problem persists, contact Pivotal Health Solutions.</i>
Elevation: Table will not raise or lower.	<ol style="list-style-type: none">1. Check to verify table is home by lowering all table sections flat in the horizontal direction.2. Check to see if cord running from foot control to control box is connected properly.3. Look for damage to controls.4. Make sure outlet is working properly.5. <i>If the problem persists, contact Pivotal Health Solutions.</i>
If you hear unusual noise.	<i>Contact Pivotal Health Solutions</i>
Orange LED on battery during use.	<ol style="list-style-type: none">1. If battery LED is blinking orange while in use, place the battery on the charger and charge the battery.2. If the battery LED goes to continuous on orange and will not charge, contact Pivotal Health Solutions.

Technical Information:

Pivotal Health Solutions will make available, upon request, circuit diagrams, component part lists, descriptions, calibration instructions, or other information that will assist service personnel.

Disposal:



Recycle and dispose of device properly in accordance with local, state and federal laws. Over the years, tons of electronics equipment with hazardous materials have been thrown away with standard garbage. Over time, these materials leech out of the electronic causing damage to the environment. It is important to try and properly dispose of retired devices in order to prevent damage to our environment.

Replacement Parts:



NOTE: Please contact Pivotal Health Solutions for replacement cushion details, or other replacement part needs. Have your table's serial number available.

<u>Part Name</u>	<u>Part Number</u>
Caster Screw Set	LDS1012
Chest Cushion (5PC, 30")	PHO-1010-xxx
Dual Foot Bar Control	S1078
Dual Foot Control Pedal	S1077
External Limit Switch	S1187
Fixed Lever Black Handle	S1123
Hand Control	S1195
Head Cushion (5PC, 30")	PT30451-xxx
Leg Cushion (5PC, 30")	PHO-1007-xxx
Wheels	S1107
Medical grade Caster	LDS1009 (PT ONLY)
Single Foot Control Pedal, Left	LDS1010 (PT ONLY)
Single Foot Control Petal, Right	LDS1011 (PT ONLY)
Stabilizer Arm Cushion	PHO-0100-xxx
Total Locking Stem Caster	S1181 (EPT ONLY)

*xxx is a place holder for the color code. Contact Pivotal Health for the appropriate color code for your table.

Warranty:

Warranty details can be found at: <https://www.phsmedicalsolutions.com/customer-service/service-and-warranty>

Note: Warranty periods listed apply only to products purchased in new condition. Any tables sold as a factory blemish or in used condition are sold 'as-is' and are limited to a (1) year warranty on the frame only, commencing on the date of delivery.

Manufacturer Contact Information:



Pivotal Health Solutions, Inc.
3003 9th Ave. SW
Watertown, SD 57201
USA



(in US) 800-743-7738



(international) 011-1-605-753-0110



Fax: 605-882-8398



Email: service@pivotalhealthsolutions.com



World Wide Web: www.pivotalhealthsolutions.com

Rev A 12/21/2022