



# ERGOSTYLE™ HYLO

**Model 9510 – 115 Volt**  
**Model 9530 – 115 Volt Autococking**  
**Model 9520 - 230 Volt**  
**Model 9540 - 230 Volt Autococking**

## Operator Manual

# TABLE OF CONTENTS

TRE-CH3 Variable Height/ Elevation Table

<b>Precautionary Instructions</b> .....	<b>3</b>
<b>Foreword</b> .....	<b>4</b>
<b>Precautionary Instructions</b> .....	<b>5-6</b>
<b>Unpacking and Installation</b> .....	<b>7</b>
<b>Nomenclature</b> .....	<b>8-9</b>
<b>Operating Instructions</b> .....	<b>11-12</b>
<b>Technical Specifications</b> .....	<b>13</b>
<b>Replacement Parts</b> .....	<b>14</b>
<b>Maintenance</b> .....	<b>15-16</b>
<b>Warranty</b> .....	<b>17</b>

## PRECAUTIONARY INSTRUCTIONS

Warning Labels: Understand these symbols and their definition before operating this equipment.



Warning: Crush Hazard

Stay clear from table when lowering.

Only patient and authorized staff should be in treatment area.

Risk of serious injury or death if table is lowered on to a child.

**KEEP ALL CHILDREN AWAY FROM TREATMENT AREA.**

This manual has been written for the operators of the ErgoStyle HYLO Table. It contains general instructions for operation, precautionary instructions, and maintenance recommendations. In order to obtain maximum life and efficiency from your ErgoStyle HYLO Table, and to assist in the proper operation of the unit, read and understand this manual thoroughly.

The specifications put forth in this manual were in effect at the time of the publication. However, owing to Pivotal Health Solutions policy of continuous improvement, changes to these specifications may be made at any time without obligation on the part of Pivotal Health Solutions.

Before administering any treatment to a patient, you should become acquainted with the operating procedures, as well as the indications, contraindications, warnings, and precautions.

Intended Use: This product is intended to support patients during evaluation and treatment in a professional medical environment.

**MD**

# PRECAUTIONARY INSTRUCTIONS

ErgoStyle™ HYLO Table

The precautionary instructions found in this section and throughout this manual are indicated by specific symbols. Understand these symbols and their definitions before operating this equipment. The definitions of these symbols are as follows:



## **CAUTION:**

Text with a “CAUTION” indicator will explain possible Safety infractions that could have the potential to cause minor to moderate injury or damage to equipment.



## **WARNING:**

Text with a “WARNING” indicator will explain possible Safety infractions that will potentially cause serious injury and equipment damage.



## **DANGER:**

Text with a “DANGER” indicator will explain possible safety infractions that are imminently hazardous situations that would result in death or serious injury.

**NOTE:** Throughout this manual “NOTE” may be found. These Notes are helpful information to aid in the particular area or function being described.



## **CAUTION**

- Read, understand, and practice the precautionary and operating instructions found in this manual. Know the limitations and hazards associated with your new treatment table. Observe any and all precautionary and operational decals placed on the unit.
- Keep table out of high moisture environments.
- This unit should be operated, transported, and stored in temperatures between 40 °F (4.4 °C) and 100 °F (37.8 °C), with relative humidity ranging from 30% - 80%.
- Unit should never be operated in an "out of level" position to the horizontal/ ground plane greater than 5°.
- Transport of this unit should always be done with the "bed" section in the horizontal position and side axis tilt no greater than 10°. The table should be left in the horizontal position (down) when not in use.
- The solid hydraulic tank plug should always be in place during table transport. Shipping the table with the breather plug may cause fluid leakage. (Refer to Unpacking and Installation Section).
- Meets IEC / EN60601-1-2 Electromagnetic Compatibility / Interference safety standard. (Care must be taken when operating this equipment around other equipment. Potential electromagnetic or other interference could occur to this or to the other equipment. Try to minimize this interference by not using other equipment in conjunction with it.)
- Use only Kendall® Four Season Mineral Based AW 46 Hydraulic Oil.



## WARNING

- U.S. Federal law restricts this device to sale by, or on the order of, a physician or licensed practitioner.
- Make certain that the unit is electrically grounded by connecting only to a grounded electrical service receptacle conforming to the applicable national and local electrical codes.
- Never place your hands or feet near the working mechanism of the table when making any and all adjustments to height or table sections.
- Do not sit or allow patients to sit on the Head Section, folding foot plate, or arm rests of the table.
- Do not lift table by Head Section, Arm Rest, or Foot Plate.
- Do not smoke on or around table.
- Do not allow any unsupervised patient access to the treatment table.
- Unit contains hydraulic fluid, which may present hazardous conditions if leakage occurs.
- In the event of visible hydraulic fluid leakage, do not attempt to use ascend or descend function of the table.



## DANGER

- Do not move or elevate any cushion section while the patient's weight is on that section.
- Do not reposition or allow the patient to get on or off table while any of the drops are in the cocked or engaged positions.
- Do not allow anything to be under the table while the table is descending.
- Do not reposition or allow the patient to get on or off the table while the table is ascending or descending.
- This table should only be operated by trained personnel familiar with the precautionary measures and operational functions associated with the table being used.

### Explanation of Symbols:



Type B equipment. Denotes the degree of protection against electric shock, particularly regarding allowable leakage currents and the reliability of the protective earth connection.



Text with a "BIOHAZARD" indicator serves to inform the user of possible hazards resulting in improper handling of components and accessories that have come in contact with bodily fluids.



Text with a "Dangerous Voltage" indicator serves to inform the user of possible hazards resulting in the electrical charge delivered to the patient in certain treatment configurations.



Equipment not suitable for use in the presence of a flammable anesthetic mixture with air, oxygen, or nitrous oxide.

# UNPACKING AND INSTALLATION

ErgoStyle™ HYLO Table

After removing top and side panels of shipping crate, you may notice metal bands and plastic straps. These are used to secure various sections of the table and must be removed before table can be lifted out. The unit must be lifted directly upward in order to clear all shipping restraints.



## WARNING

Do not lift the table by the Head Section, Arm Rest, or Foot Plate.

**A MINIMUM OF TWO PEOPLE WILL BE REQUIRED TO LIFT AND/OR MOVE THE TABLE. TABLE SHOULD BE LIFTED BY THE BASE FRAME.**



## CAUTION

Meets FCC Part 15 Class A and IEC/EN60601-1-2 Electromagnetic Compatibility/Interference safety standard. (Care must be taken when operating this equipment around other equipment. Potential electromagnetic or other interference could occur to this or to the other equipment. Try to minimize this interference by not using other equipment in conjunction with it.)

### Adjustment of Glide Levelers:

Use a carpenter's level (fluid bubble type) to make adjustments to each Glide Leveler of the table and tighten each glide with a regular crescent wrench. The footplate of the table should rest on the floor when the table is fully tilted in the up position. Rear glide levelers should be set in the lowest position possible.



## CAUTION

Make certain that the footplate of the table is resting on the floor when the table is fully tilted in the up position or table instability could occur.



A

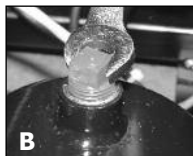

B

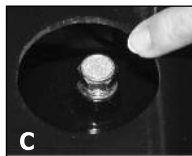

C

### Installation of Breather Plug:

Remove the oil plug cap from the hydraulic cover with a flat screwdriver (A).

Unscrew and remove the solid hydraulic plug with a 3/8" wrench (B) , and install the breather plug with a 9/16" wrench (C).

(Breather plug can be found in Installation Kit with table.)

# NOMENCLATURE

ErgoStyle™ HYLO Table

Models 9510 & 9520 (Manual) and 9530 & 9540 (Auto-Cocking) Shown with 95004 Headpiece

- |  |  |
|--|--|
| 1. Head Cushion Adjustment               | 10. Pelvic Drop Tension Control                    |
| 2. Forward Drop Cocking Lever            | 11. Pelvic Drop Cocking Lever                      |
| 3. Headpiece Elevation Release Lever     | 12. Tilt Release Button                            |
| 4. Headpiece Tilt Release Lever          | 13. Breakaway / Elevating Chest Release Lever      |
| 5. Forward / Toggle Drop Tension Control | 14. Pelvic Elevation Release Lever                 |
| 6. Thoracic Drop Tension Control         | 15. Pelvic Section Gap Adjustment                  |
| 7. Thoracic Drop Cocking Lever           | 16. Combined Section Adjustment for Patient Height |
| 8. Lumbar Drop Tension Control           | 17. Glide Levelers                                 |
| 9. Lumbar Drop Cocking Lever             | 18. Foot Plate                                     |

## NOMENCLATURE

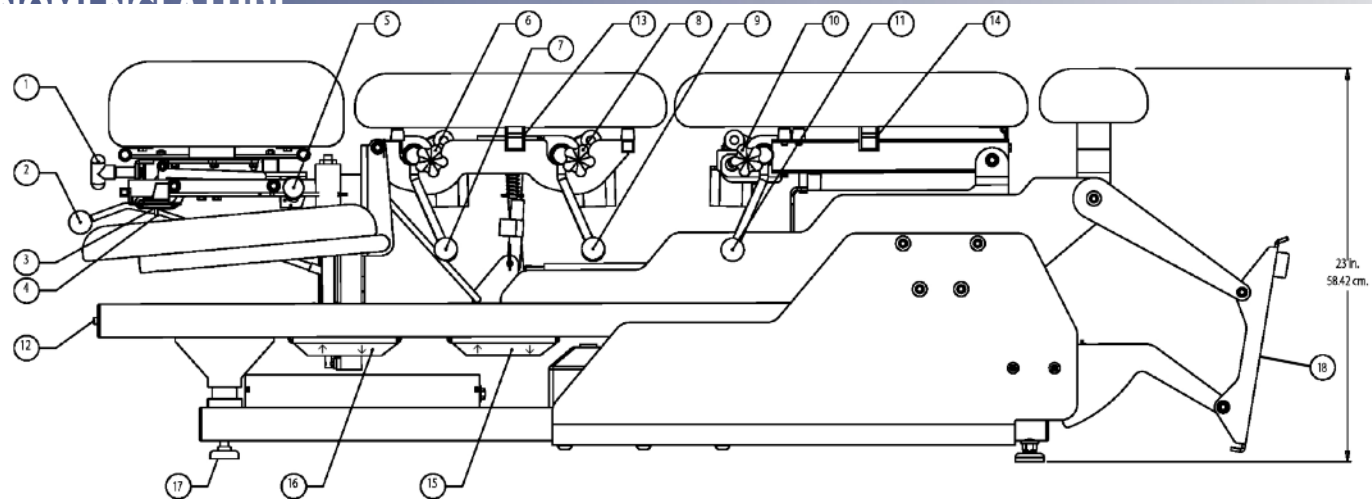

# NOMENCLATURE

ErgoStyle™ HYLO Table

Model 9510 & 9520 (Manual) and 9530 & 9540 (Auto-Cocking) Shown with 95004 Headpiece

- (A) Ankle Rest Cushion
- (B) Pelvic Cushion
- (C) Thoracic/Lumbar Cushion
- (D) Head Piece Cushion
- (E) Arm Rest Cushion

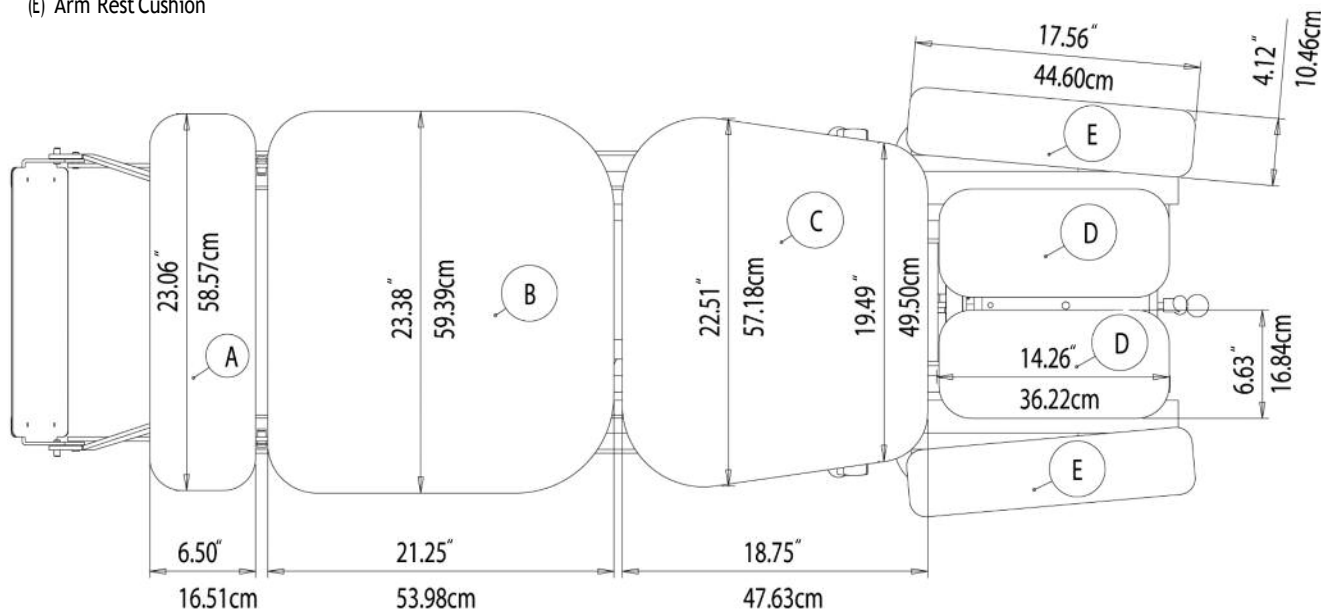

# OPERATING INSTRUCTIONS

ErgoStyle™ HYLO Table

**Note to user:** If a serious incident occurs, report the incident to Pivotal Health solutions. (See Manufacturer contact information on last page). If the incident occurs in the EU, also report any serious incident to the Competent Authority of the Member State in which the user and/or patient is established.

The Toggle drop can be cocked by pulling up on the back portion of the head cushion closest to the thoracic/lumbar cushion. To adjust the holding ability of the drop section, turn the Forward/Toggle Drop Tension Release Control (#5 from Page 5) to increase or decrease holding ability. The toggle drop will fall in a straight down motion.

## **Break-a-way/Elevating Chest (Optional)**

The chest section of the table can be adjusted for spring action or positioned to hold at various angles. To unlock the chest section, pull the Break-a-way/Elevating Chest Release Lever (#13 from Page 5). To position the chest section of the table to a particular angle, first unlock the Break-a-Way/Elevating Chest Release Lever (#13 from Page 5), move the chest section to the desired angle, then release the Break-a-way/Elevating Chest Release Lever (#13 from Page 5) to hold the new position.

## **Thoracic Drop (Optional)**

To cock the Thoracic Drop, pull up on the Thoracic Drop Cocking Lever (#7 from Page 5). To adjust the holding ability of the drop section, turn the Thoracic Drop Tension Control (#6 from Page 5) to increase or decrease holding ability.

## **Lumbar Drop (Optional)**

To cock the Lumbar Drop, pull up on the Lumbar Drop Cocking Lever (#9 from Page 5). To adjust the holding ability of the drop section, turn the Lumbar Drop Tension Control (#8 from Page 5) to increase or decrease holding ability.

## **Combined Section Adjustment**

To adjust for patient height, make sure the table is in the full tilt position (63°) and push the Combined Section Adjustment (#16 from Page 5) arrows up or down to move the headpiece cushion, the lumbar/thoracic cushion and the pelvic cushion.

## **Pelvic Section Adjustment**

To adjust for possible pelvic gap after using the Combined Section Adjustment, push the Pelvic Section Adjustment (#15 from Page 5) arrows up or down to move the pelvic cushion.

# OPERATING INSTRUCTIONS

ErgoStyle™ HYLO Table

## Pelvic Elevation (Optional)

The pelvic section of the table can be adjusted for spring action or positioned to hold at various angles. To unlock the pelvic section, pull the Pelvic Elevation Release Lever (#14 from Page 5). To position the pelvic section of the table to a particular angle, first unlock the Pelvic Elevation Release Lever (#14 from Page 5), move the pelvic section to the desired angle, then release the Pelvic Elevation Release Lever (#14 from Page 5) to hold the new position.

## Pelvic Drop (Optional)

To cock the Pelvic Drop, pull up on the Pelvic Drop Cocking Lever (#11 from Page 5). To adjust the holding ability of the drop section, turn the Pelvic Drop Tension Control (#10 from Page 5) to increase or decrease holding ability.

## Table Tilt Adjustment

Press Foot Control to tilt or lower the table. Tilting range is from 0° to 63°.

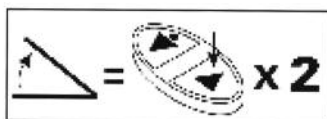
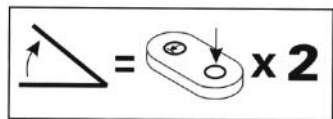

To tilt the table, press the “UP” switch on the foot pedal twice.

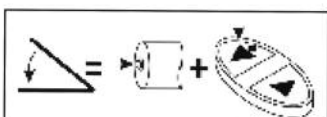
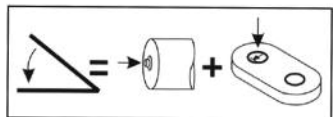

To lower the table, press the Tilt Release Button. (#12 from Page 5), then the “DOWN” switch on the foot pedal.

**Note: During tilt operation, pressing any switch or pedal on table will stop movement.**

# TECHNICAL SPECIFICATIONS

ErgoStyle™ HYLO Table

## Motor.....115 V Version ..230 V Version

Model.....1/3 Horsepower AC ....1/3 Horsepower AC

Rated Voltage .....115 V .....230 V

Rated Frequency .....60/50 Hz .....60/50 Hz

Current .....5.8 A/4.8 A .....2.4 A/1.9 A

Fuse .....T10 L250 V .....3.15 A

Lifting Capacity .....181 kg (400 lbs).....181 kg (400 lbs)

Electrical Classification ..Class I .....Class 1

Electrical Type.....Type "B".....Type "B"

Duty Cycle .....Intermittent-Max. 1 minute on, 9 minutes off

## TABLE SYMBOL DEFINITIONS



Warning: Pinch Point



Patient Support: Orthogonal Movement to its Plane



Warning: Pinch PointPatient Cradle: Rotation about its axis



Patient Support: Longitudinal Movement



Patient Support: Tilting



Crush hazard.

# REPLACEMENT PARTS

ErgoStyle™ HYLO Table

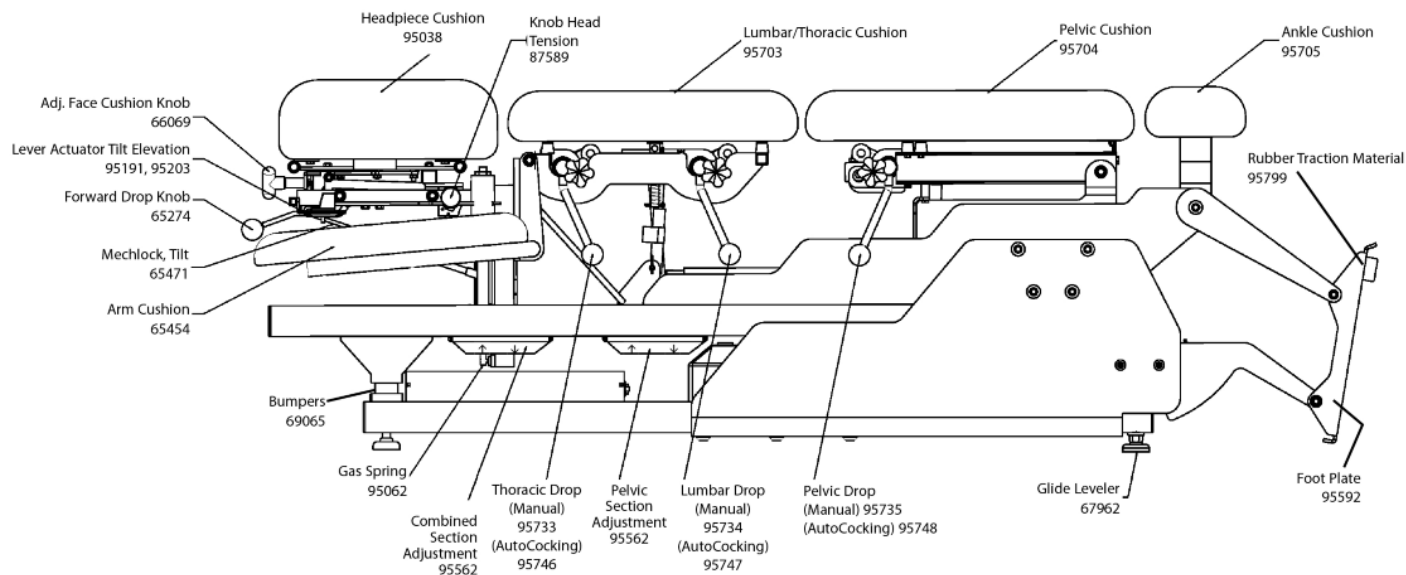

## CLEANING

After each use, clean the unit using a soft cloth dampened with water and a mild antibacterial detergent.

## SERVICE

Should the ErgoStyle HYLO Table require service, contact the selling dealer or Pivotal Health Solutions Service Department.

All returned units to the factory for service must include the following:

### WARRANTY REPAIR/OUT OF WARRANTY REPAIR

1. Written statement containing the following information:
  - RA Number - Obtain from Factory
  - Unit Model Number
  - Unit Serial Number
  - Contact person with Phone and Fax Numbers
  - Billing Address (for Out of Warranty Repair)
  - Shipping Address (Where to Ship Unit after Repair)
  - Detailed Description of Problem or Symptoms
2. Copy of original invoice issued at purchase of the unit.
3. Ship unit to Factory in the original container with all accessories and information as required in item one above to:

Pivotal Health Solutions  
3003 9<sup>th</sup> Ave. SW  
Watertown, SD U.S.A.  
Phone: +1-605-753-0110  
FAX: +1-605-882-8398  
[www.pivotalhealthsolutions.com](http://www.pivotalhealthsolutions.com)

Through the purchase of a Service Manual, Pivotal Health Solutions has made available circuit diagrams, component parts lists, descriptors, or other information which will assist authorized technical personnel to repair those parts of the equipment which are designated by Pivotal Health Solutions as repairable.



Council Directive 2002/96/EC concerning Waste Electrical and Electronic Equipment (WEEE). Indicates a requirement not to dispose of WEEE as municipal waste. Contact your local distributor for information regarding disposal of the unit and accessories.

Service to these units should be performed only by Service Technicians certified by Pivotal Health Solutions.

# MAINTENANCE

At least once a month, the table should be thoroughly inspected by a person qualified to recognize any signs of wear and tear, and looseness of bolts or parts. Replace any worn parts immediately. Check periodically for leaks. Contact the Pivotal Health Solutions Service Department should any leakage occur.

To lubricate, put a drop of oil on the following points of the ErgoStyle HYLO Table as needed:.

**Note:** To lubricate the table, use a type of grease (ex: lithium grease) or a 3-in-1 oil. Do not use WD-40 or a similar type of lubricant.

- |  |  |
|--|--|
| 1. Slide Bar- front to back on both sides of table                 | 5. Pelvic Hinge Point- both sides of table         |
| 2. Slide Rod- front to back on both sides of table                 | 6. Footplate Pivot Arm Hinge- both sides of table. |
| 3. Chest Hinge Point- both sides of table                          | 7. Footplate Pivot Joints- both sides of table     |
| 4. Threaded Tension Fitting on Pelvic Drop Control (Chrome Plated) |  |

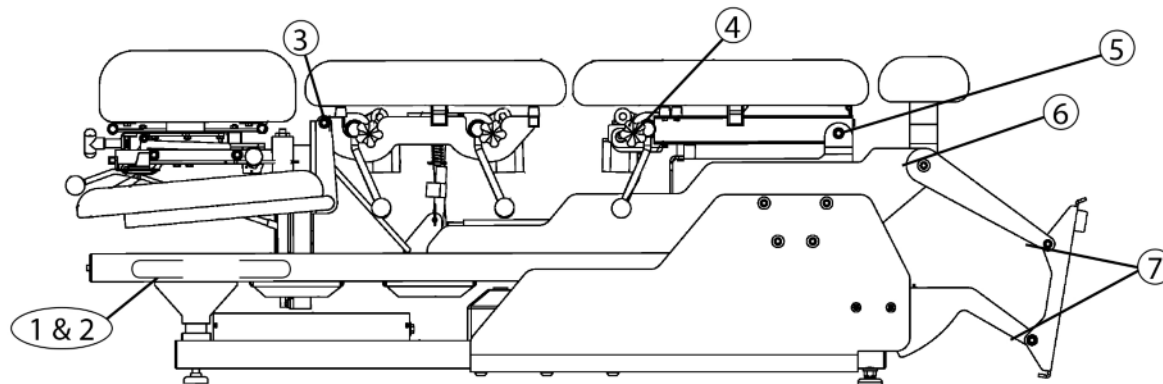

Do not lubricate the main pivots on both sides of the table, the Mechlok® Head and Chest Support Mechanisms, or anything with a yellow plastic bushing on the ErgoStyle HYLO.

Mechlok® is a registered trademark of P.L. Porter in Woodland Hills, California.

# WARRANTY

ErgoStyle™ HYLO Table

Pivotal Health Solutions. ("Company"), warrants that the ErgoStyle HYLO Table ("Product") is free of defects in material and workmanship. This warranty shall remain in effect for one years (12 months) from the date of original consumer purchase. If this Product fails to function during the one year warranty period due to a defect in material or workmanship, Company or the selling dealer will repair or replace this Product without charge within a period of thirty days from the date on which the Product is returned to the Company or the dealer. In addition, the company offers an additional 12 months (1 year) of parts replacement, with the purchaser being responsible for repair (labor) costs.

All repairs to the Product must be performed by a service center certified by the Company. Any modifications or repairs performed by unauthorized centers or groups will void this warranty.

## **This Warranty Does Not Cover:**

- Replacement parts or labor furnished by anyone other than the Company, the selling dealer, or a service technician certified by the Company.
- Defects or damage caused by labor furnished by someone other than Company, the selling dealer, or a certified Company service technician.
- Any malfunction or failure in the Product caused by product misuse, including, but not limited to, the failure to provide reasonable and required maintenance or any use that is inconsistent with the Product User's Manual.

## **COMPANY SHALL NOT BE LIABLE IN ANY EVENT FOR INCIDENTAL OR CONSEQUENTIAL DAMAGES.**

Some locations do not allow the exclusion or limitation of incidental or consequential damages, so the above limitation or exclusion may not apply to you. To obtain service from Company or the selling dealer under this warranty:

1. A written claim must be made within the warranty period to the Company or the selling dealer. Written claims made to the Company should be sent to:

Pivotal Health Solutions  
3003 9<sup>th</sup> Ave. SW  
Watertown, SD U.S.A.  
Phone: +1-605-753-0110  
FAX: +1-605-882-8398  
[www.pivotalhealthsolutions.com](http://www.pivotalhealthsolutions.com)

2. The Product must be returned to the Company or the selling dealer by the owner. This warranty gives you specific, legal rights and you may also have other rights which vary from location to location. The Company does not authorize any person or representative to create for it any other obligation or liability in connection with the sale of the Product. Any representation or agreement not contained in the warranty shall be void and of no effect.

**THE FOREGOING WARRANTY IS IN LIEU OF ALL OTHER WARRANTIES, EXPRESSED OR IMPLIED,  
INCLUDING ANY WARRANTY OR MERCHANTABILITY OR FITNESS FOR A PARTICULAR PURPOSE**



**Manufacturer:**



3003 9<sup>th</sup> Ave. SW  
P.O. Box 1060  
Watertown, SD 57201 USA  
Telephone: 800-743-7738  
Outside USA: +1-605-753-0110  
Fax: 605-882-8398

**[www.PivotalHealthSolutions.com](http://www.PivotalHealthSolutions.com)**  
rev D 05-21



**EMERGO EUROPE**  
Prinsessegracht 20  
2514 AP The Hague  
The Netherlands